

S-2G -#31, #55 (EMD #8494445) same orifices as below
S-2H -#48, #37 (EMD #8494444)

Orifices:

#31: 0.109

#37: 0.095

#48: 0.080

#55: 0.080

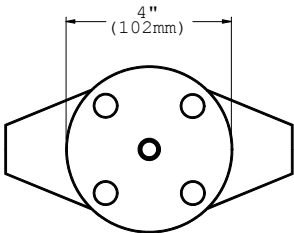
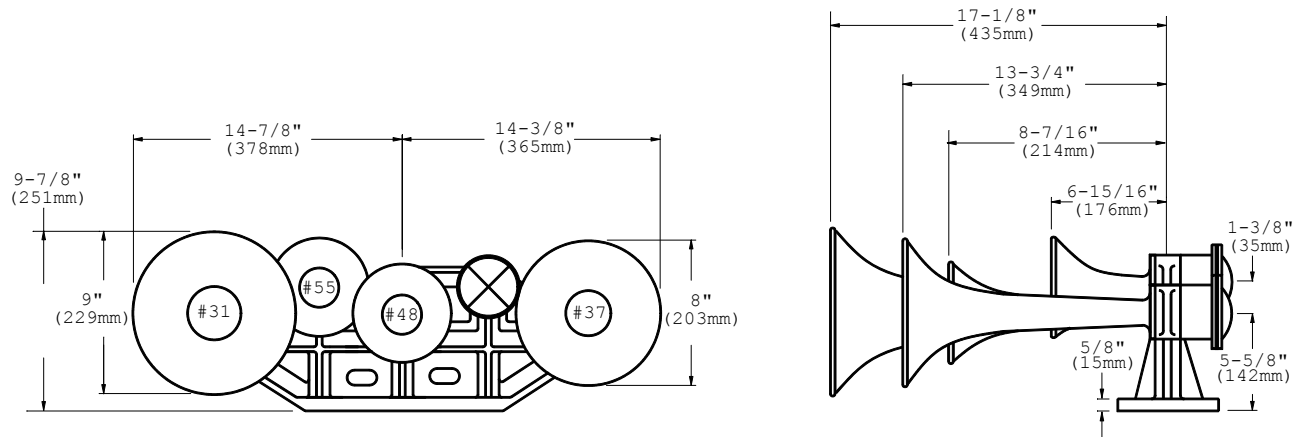

MOUNTING FLANGE

TAPPED IN CENTER FOR 1/2" PIPE
FOUR 9/16" HOLES EQUALLY SPACED
AND STRADDLING CENTER LINE ON
3" DIAMETER BOLT CIRCLE

HORNS SHOWN LOOKING
INTO BELL END

NO.	REVISION	C N NO	APP'D	DATE
TOLERANCE UNLESS OTHERWISE SPECIFIED .00 = ± .010 .000 = ± .005 .0000 = ± .0005 FRACTIONAL ± 1/64 ANGULAR ± 1/2 DIMENSIONS IN INCHES MACHINED SURFACES = 125 ▽ TOLERANCE NON - ACCUMULATIVE		LESLIE C.O. LYNDHURST NEW JERSEY		
LESLIE - SUPERTYFON CHIME WHISTLES CLASS SL-4T RE-ISSUED BY DHE, JAN. 2004				
SIZE NONE	DATE 1-23-73	DWG. NO. SK MS 1-23-73		REV 1
D'W'N	C'K'D JR			